



# SIDDHI CONSTRUCTION

Mobile : 9836185240

## Developers

Office : 82A, N.K. Ghosal Road, Kolkata - 700 042  
Branch Office : 269, B.B. Chatterjee Road, Kolkata - 700 042

Ref. No. ....

Date .....

Location Map with Latitude and Longitude for the Project named **SIDDHI OPAL** at Premises No. 14, Rajkrishna Ghoshal Road, under Ward No. 91 of Borough – X of KMC, PS - Kasba, Kolkata – 700042, WB, India:

LATITUDE	LONGITUDE
22.517261	88.376637

North

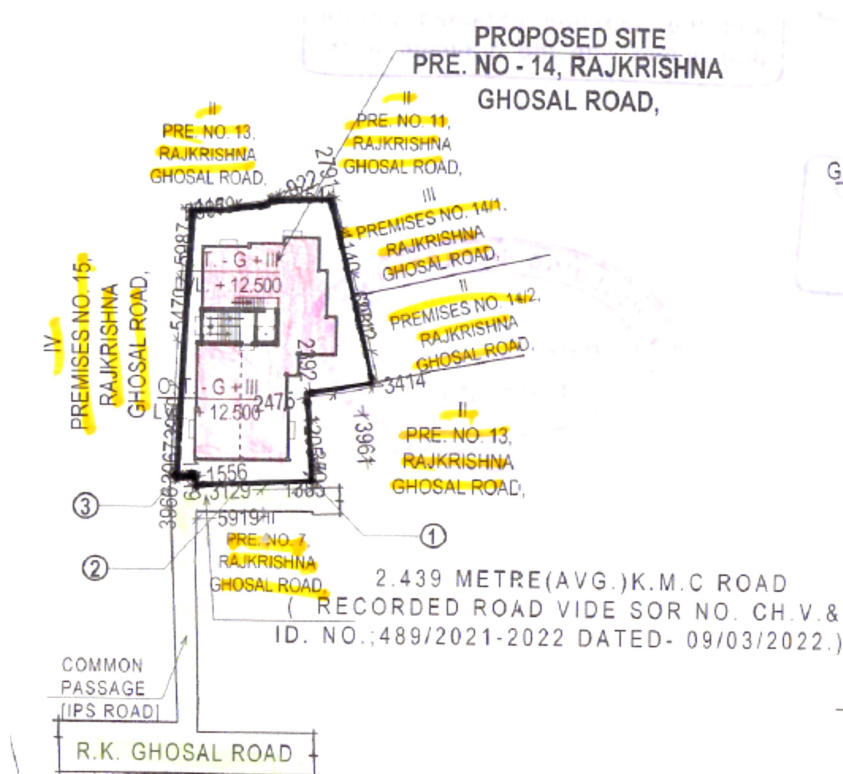
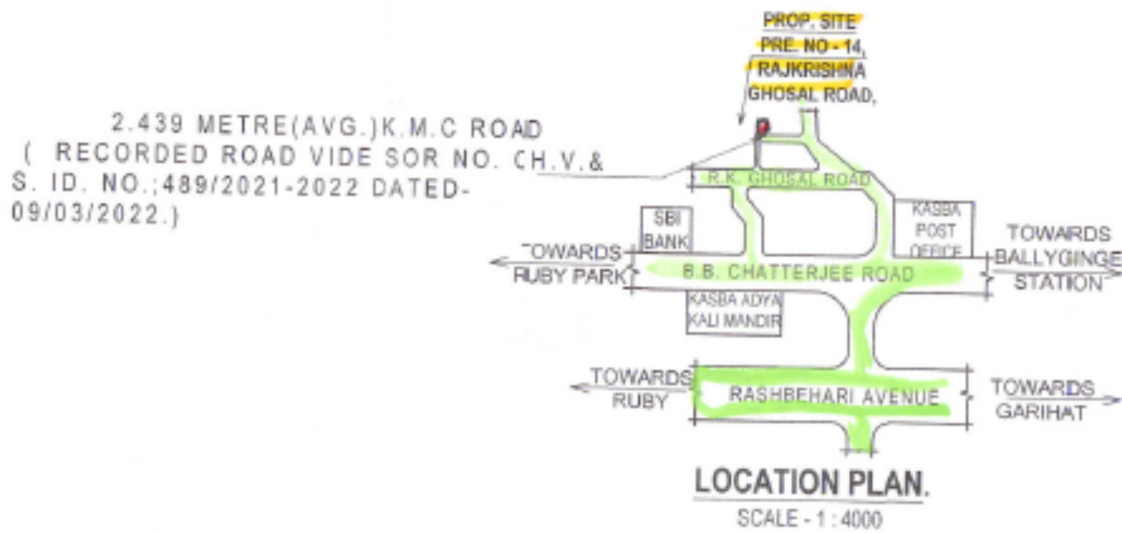

Date: 02-07-2025

SIDDHI CONSTRUCTION

*Samay Gupta*  
Partner

*Satyajit Bujin*  
Partner